

## Popper Cam Base



### Description

The Popper Cam Base is used in conjunction with a "3-jaw Popper Pull-off Fixture" to test the strength of poppers and press studs, particularly on childrens clothing. The Popper Cam Base is secured to the base of the test stand and the popper is fed through the retaining hole and positioned over the retaining post. The lever of the cam mechanism is locked off to raise the popper within the fabric so that it can easily be attached to the upper "3-jaw Popper Pull-off Fixture" to perform a tensile pull-off test on 13-15 ligne poppers.

### Applications

Used by clothing manufacturers for test-to-failure testing for compliance with BS 7907:2007 on

- poppers and press studs

### Specifications

Maximum Capacity	Maximum Specimen Dimensions	Weight	Height
500N (50kgf, 110lbf)	13-15 ligne poppers	760g (1.7lbs)	75mm (2.95")

ACCESSORY PART NO. 432-179

## Dimensions mm (inch)

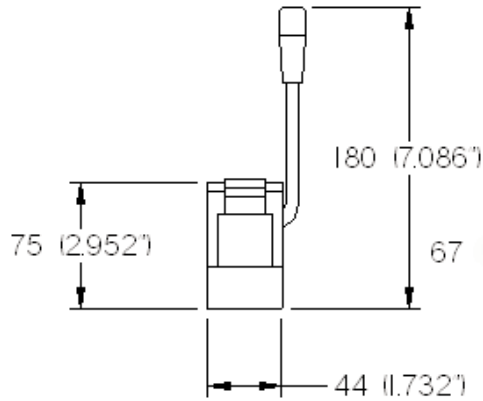

Front View

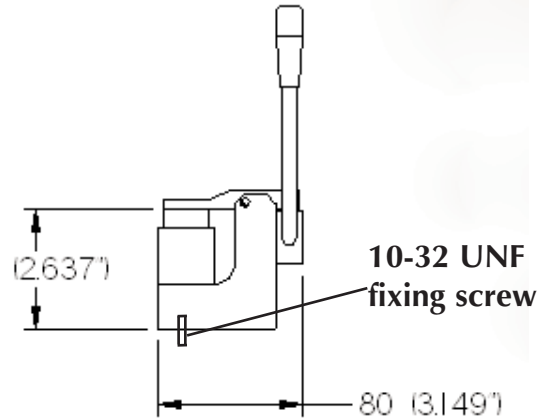

Side View

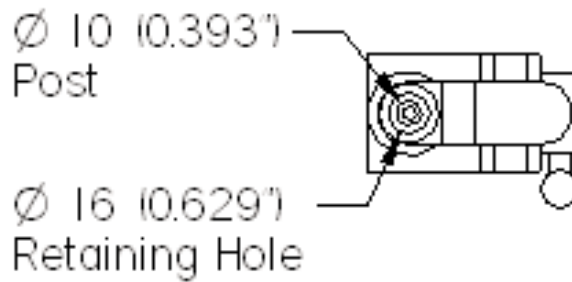

Top View

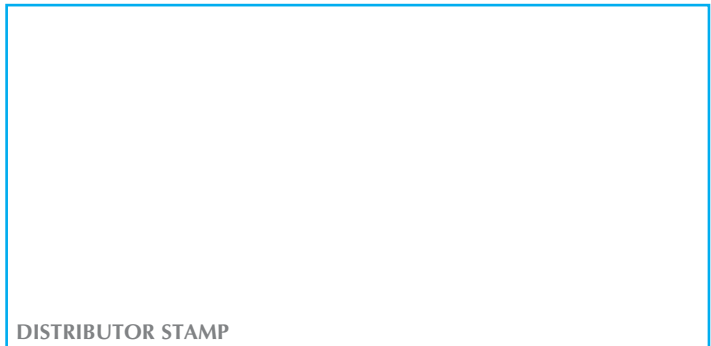

431-354-27-1

Mecmesin reserves the right to alter equipment specifications without prior notice.

**Head Office**  
**Mecmesin Limited**  
 Newton House, Spring  
 Copse Business Park,  
 Slinfold, West Sussex,  
 RH13 0SZ, UK  
 e. sales@mecmesin.com  
 t. +44 (0) 1403 799979  
 f. +44 (0) 1403 799975

**North America**  
**Mecmesin Corporation**  
 45921 Maries Road,  
 Suite 120, Sterling  
 Virginia 20166,  
 U.S.A.  
 e. info@mecmesincorp.com  
 t. +1 703 433 9247  
 f. +1 703 444 9860

**Asia**  
**Mecmesin Asia Co. Ltd**  
 91/1 Chaiyo Building, 11th Floor,  
 Room 1106, Rama 9 Road, Huaykwang,  
 Bangkok, 10310,  
 Thailand  
 e. sales@mecmesinasia.com  
 t. +66 2 247 46 81  
 f. +66 2 247 46 82

**China**  
**Mecmesin (Shanghai) Pte Ltd**  
 Room 302, No. 172,  
 Daxue Lu - University Avenue,  
 Yangpu District, Shanghai, 200433  
 People's Republic of China  
 e. sales@mecmesin-china.com  
 t. +86 21 5566 1037 / 3377 1733  
 f. +86 21 5566 1057